

Accesorios mecánicos Ø 45

Adaptadores Ø 45 mm

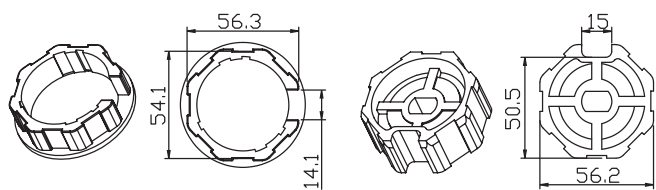

CORONA

POLEA

001 YK 5101

Octogonal 59 x 0.6 mm.

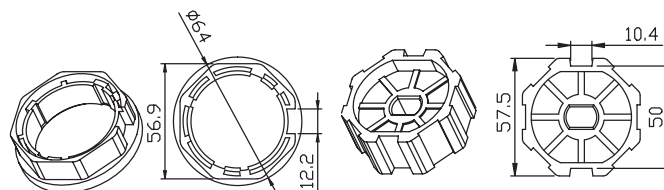

CORONA

POLEA

001 YK 5102

Octogonal 60 x 0.8 mm.

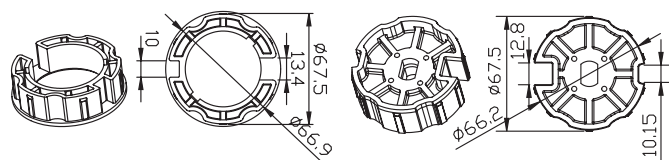

CORONA

POLEA

001 YK 5103

Ojiva 70 x 1 mm.

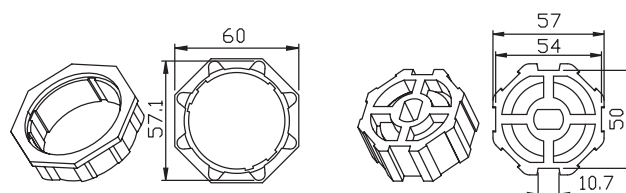

CORONA

POLEA

001 YK 5104

Octogonal 59 x 0.7 mm.

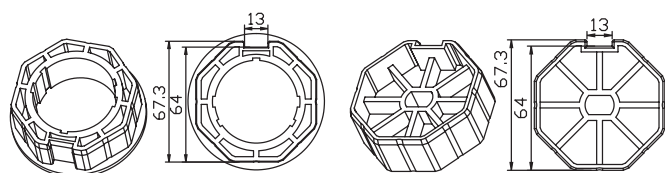

CORONA

POLEA

001 YK 5105

Octogonal 70 x 1.2 mm.

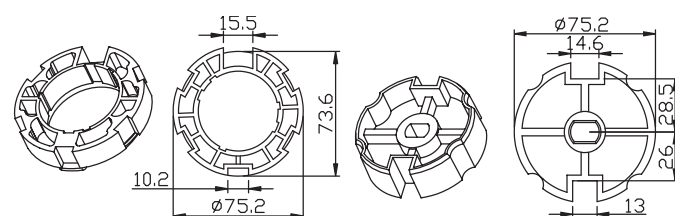

CORONA

POLEA

001 YK 5106

Ojiva 78 x 1.2 mm.

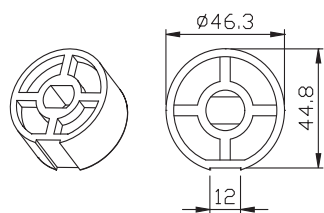

POLEA

001 YK 5107

Redondo 50 x 1.5 mm.

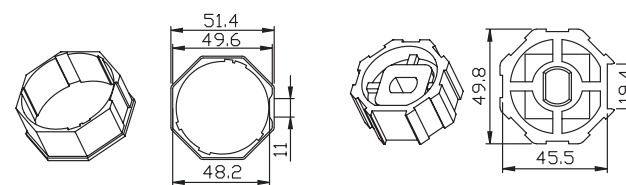

CORONA

POLEA

001 YK 5108

Octogonal 52 x 0.6 mm
excéntrico 0.6 mm.



Accesorios mecánicos Ø 45

Adaptadores Ø 45 mm

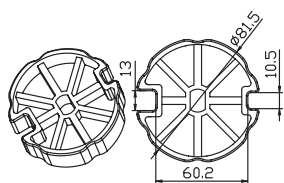
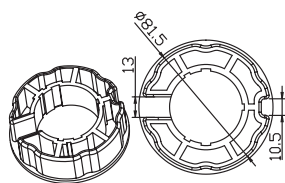

CORONA

POLEA

001YK5111

Ojiva 85 x 1.2 mm.

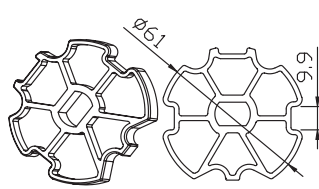
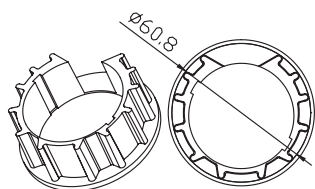

CORONA

POLEA

001YK5112

Redondo Z.F. 64 x 1 mm.

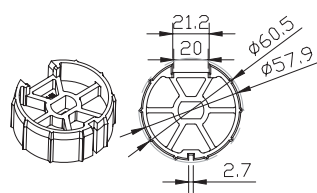
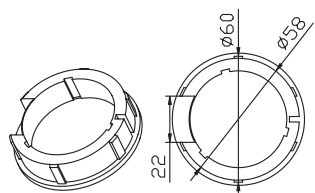

CORONA

POLEA

001YK5115

Ojiva DEPRAT 62 x 0.6 mm.

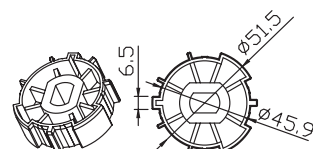
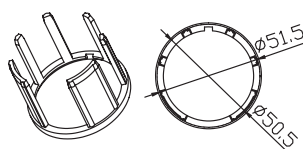

CORONA

POLEA

001YK5116

Redondo Z.F. 54 x 0.5 mm.

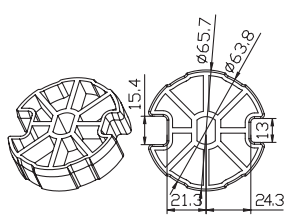
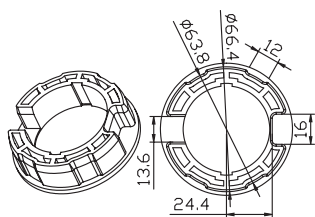

CORONA

POLEA

001YK5120

Redondo 70 x 1.5 mm.



Accesorios mecánicos Ø 45

Adaptadores Ø 45 mm

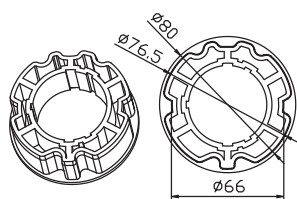

CORONA

001YK 5123

Redondo Z.F. 80 x 1 mm.

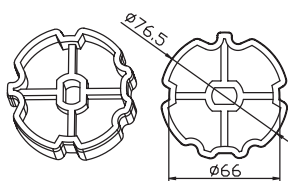

POLEA

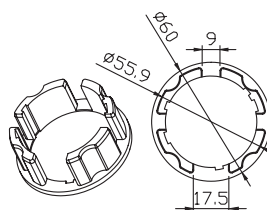

CORONA

001YK 5128

Redondo 58 x 0.8 mm.

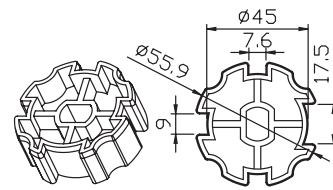

POLEA

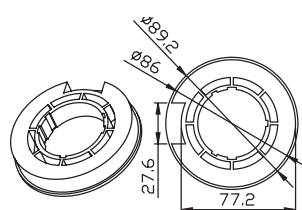

CORONA

001YK 5127

Redondo DEPRAT
89 x 1 mm.

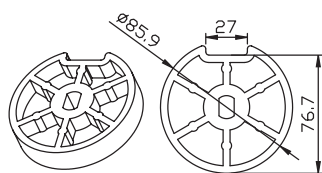

POLEA

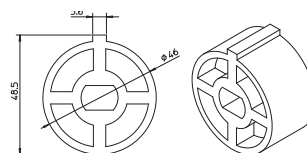

POLEA

001YK 5131

Redondo 50 x 1.5 mm
con llave S.

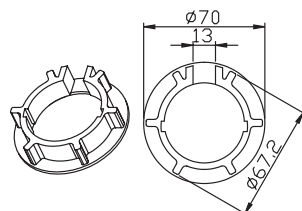

CORONA

001YK 5129

Redondo 71 x 1.5 mm
excéntrico 2 mm.

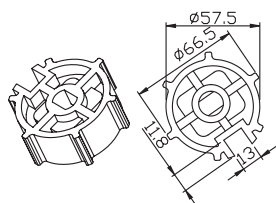

POLEA

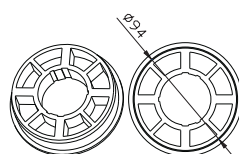

CORONA

001YK 5133

Redondo 101.9 x 3.5 mm.

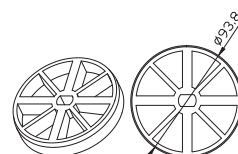

POLEA

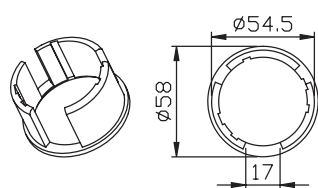

CORONA

001YK 5132

Redondo 57 x 1.5 mm.

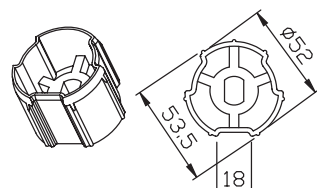

POLEA

Accesorios mecánicos Ø 45

Adaptadores Ø 45 mm

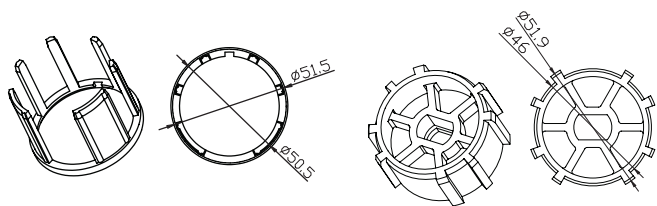

CORONA

POLEA

001 YK 5134

Redondo DEPRAT 53 x 0.6 mm.

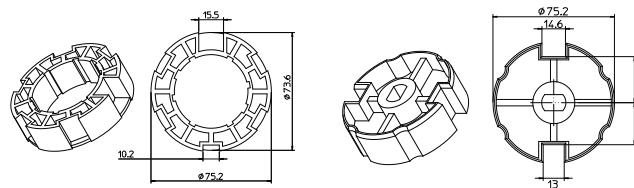

CORONA

POLEA

001 YK 5135

Ojiva 78 x 1.5 mm alojamiento 13 x 13 mm.

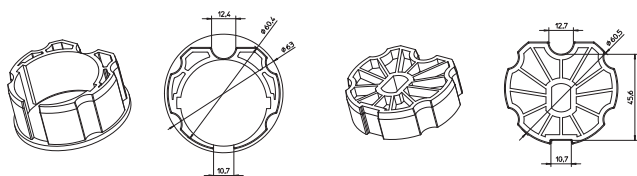

CORONA

POLEA

001 YK 5137

Ojiva inclinada 63 mm.

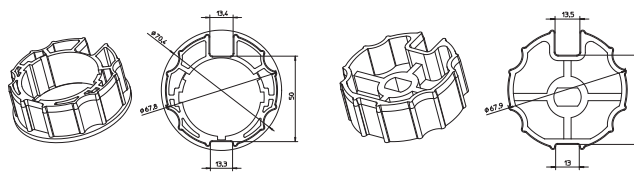

CORONA

POLEA

001 YK 5138

Ojiva inclinada 70 mm.

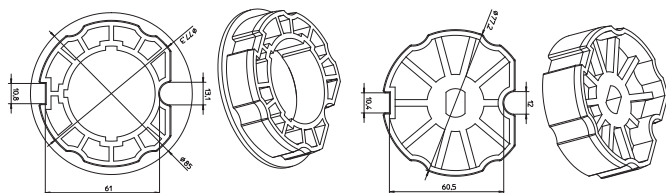

CORONA

POLEA

001 YK 5139

Ojiva inclinada 80 mm.



Accesorios mecánicos Ø 45

Soportes Ø 45 mm

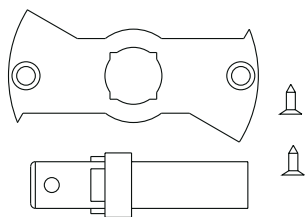

001 YMD105

Perno de seguridad
Q10 MOM 5.

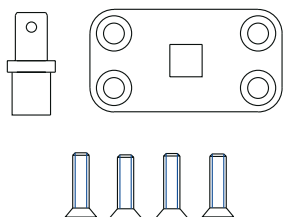

001 YMD106

Perno de seguridad
Q10 MOM 5.

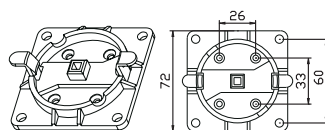

001 YMD108

Enganche rápido M0 5
con Q10 de plástico máx
20 Nm.

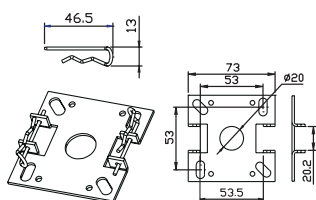

001 YMD109

Soporte con pasador M0 5
máx 30 Nm.

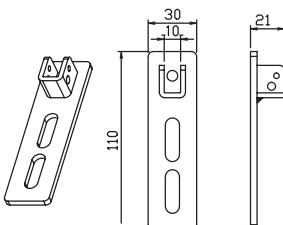

001 YMD110

Soporte regulable doble
ranura apoyo Q10.

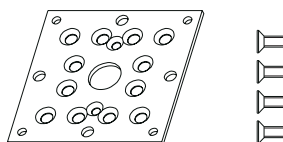

001 YMD111

Placa multi-perforada para:
MOM 5, MOM 6 y M06.

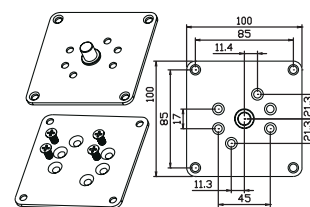

001 YMD112

Placa con perno para:
MOM 5 y M06.

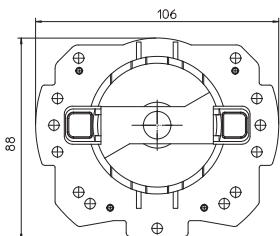

001 YMD113

Soporte rápido M0 5 de
plástico
para lateral ZF máx 20 Nm.

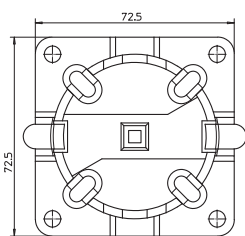

001 YMD114

Soporte rápido M0 5 con
perno Q10
de plástico máx 30 Nm.
Intereje 48/60 mm.

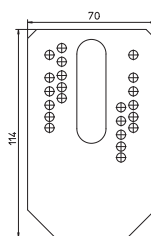

001 YMD115

Placa multi-perforada para
laterales con perno.

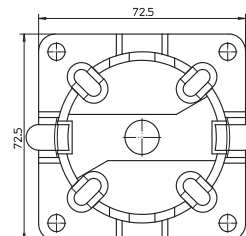

001 YMD116

Enganche rápido M0 5 con
taladro de plástico máx
20 Nm.
Intereje 48/60 mm.



001 YMD107

Soportes para enrollables
tubos de 50/53/58 mm.

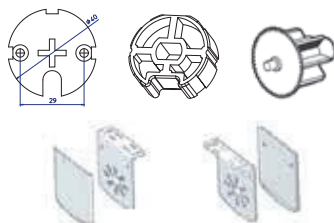

001 Y 9992

Blanco soporte 55.

Accesorios mecánicos Ø 45

Soportes Ø 45 mm

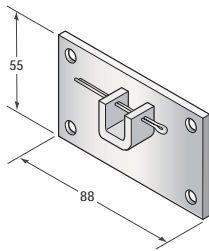

001 YMD004

Soporte 88 x 55 mm con apoyo Q10.

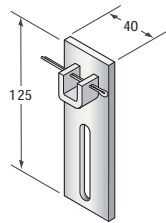

001 YMD005

Soporte regulable apoyo Q10.

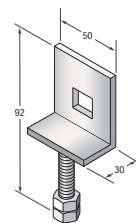

001 YMD010

Soporte de tornillo M10 alojamiento Q10.

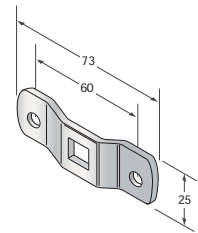

001 YMD011

Omega de interjeje 60 mm alojamiento Q10.

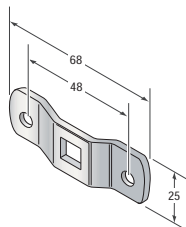

001 YMD014

Omega de interjeje 48 mm alojamiento Q10.

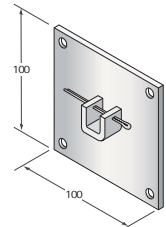

001 YMD018

Soporte 100 x 100 mm con apoyo Q10.

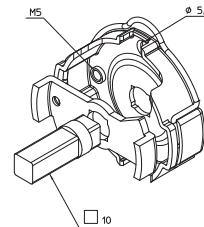

001 YMD127

Soporte metálico para M0 5.

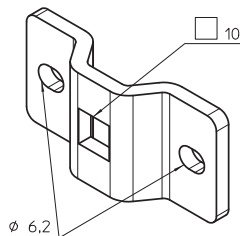

001 YMD137

OMEGA Q10 interjeje 44-48 mm.

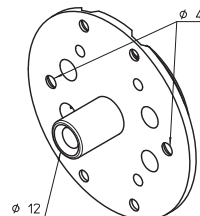

001 YMD138

Soporte para pletina ALUPLATIC.

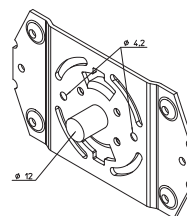

001 YMD139

Soporte para lateral KOMMERLING.

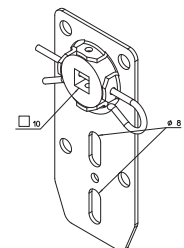

001 YMD140

Soporte regulable con pasador para Q10.

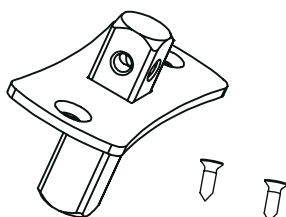

001 YMD145

Perno Q10 dedicado al motor Matta 5.

Tablas de carga para toldos

Toldos

SALIDA TOLDO 1,5 m						
Ø TUBO mm	N. BRAZOS					
	2	4	6	8	10	12
50	20 Nm	30 Nm	40 Nm	50 Nm	-	-
63 / 70	30 Nm		50 Nm	80 Nm		100 Nm
78	30 Nm	50 Nm	80 Nm	-	-	-
85	50 Nm	80 Nm	100 Nm	-	-	-

■ 20 Nm ■ 30 Nm ■ 40 Nm ■ 50 Nm ■ 80 Nm ■ 100 Nm ■ 120 Nm

SALIDA TOLDO 2 m						
Ø TUBO mm	N. BRAZOS					
	2	4	6	8	10	12
50	20 Nm	30 Nm	40 Nm	50 Nm	-	-
63 / 70	30 Nm	40 Nm	50 Nm	80 Nm	100 Nm	120 Nm
78	30 Nm	50 Nm	80 Nm	-	-	-
85	50 Nm	80 Nm	100 Nm	-	-	-

■ 20 Nm ■ 30 Nm ■ 40 Nm ■ 50 Nm ■ 80 Nm ■ 100 Nm ■ 120 Nm

SALIDA TOLDO 3,5 m						
Ø TUBO mm	N. BRAZOS					
	2	4	6	8	10	12
50	40 Nm	50 Nm	-	-	-	-
63 / 70	50 Nm	80 Nm	100 Nm	120 Nm	-	-
78	80 Nm	100 Nm	120 Nm	-	-	-
85	100 Nm	120 Nm	-	-	-	-

■ 20 Nm ■ 30 Nm ■ 40 Nm ■ 50 Nm ■ 80 Nm ■ 100 Nm ■ 120 Nm

SALIDA TOLDO 5 m						
Ø TUBO mm	N. BRAZOS					
	2	4	6	8	10	12
50	-	-	-	-	-	-
63 / 70	80 Nm	100 Nm	120 Nm	-	-	-
78	100 Nm	120 Nm	-	-	-	-
85	120 Nm	-	-	-	-	-

■ 20 Nm ■ 30 Nm ■ 40 Nm ■ 50 Nm ■ 80 Nm ■ 100 Nm ■ 120 Nm

Tablas de carga para persianas



Ø 45 Para aplicaciones en persianas de hasta 1,5 m de luz libre

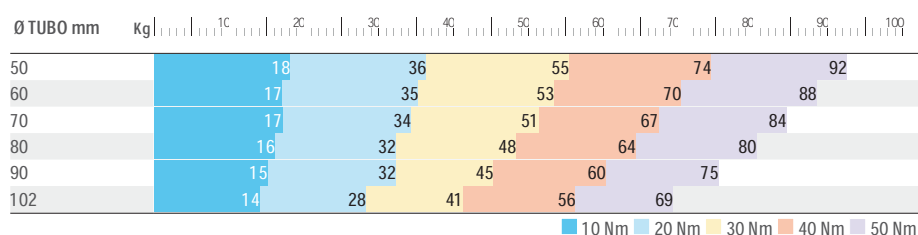

Ø 45 Para aplicaciones en persianas de hasta 2,5 m de luz libre

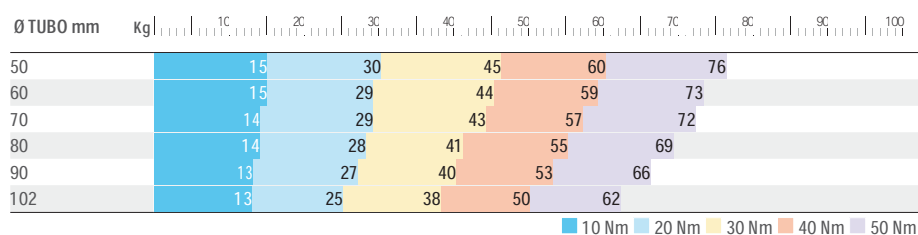

El peso de la persiana

Tabla indicativa de pesos

Pesos específicos indicativos de los materiales más utilizados para la fabricación de persianas:

Materiales	desde Kg/m ²	hasta Kg/m ²
PVC	3	6
MADERA	10	15
ALUMINIO	4	8
ACERO	10	12